



The Interface has various functions so here is a list of them all:

- **Press Wheel IN/SRC** - Enter Menu & Select once in Menu & SOURCE in Radio operation.
- **VOL +/-VOL** - Works just the same
- **Wheel UP/DOWN** - navigate menu up/down & seek up/down in Radio operation
- **HANG-UP/MUTE** - Back in menu & Mute in Radio operation

## Settings

This is the first screen of the menu, you can make any selection you wish from here.

**Time Date**  
**Vehicle Settings**  
**Logo Select**

## Settings

Now if you press DOWN on the wheel the highlighted item will change to the one below.

**Time Date**  
**Vehicle Settings**  
**Logo Select**

## Settings

**LOGO SELECT** on the menu is the one that is required.

**Time Date**  
**Vehicle Settings**  
**Logo Select**

## Settings

Press **IN** on the SRC/WHEEL to go into the **LOGO SELECT** settings.

☒ **Kenwood**  
☐ **Vauxhall**  
☐ **Opel**

## Settings

Now you can scroll **UP/DOWN** on the SRC/WHEEL to select the required setting you want to appear on the display.

☐ **Kenwood**  
☐ **Vauxhall**  
☒ **Opel**

## Settings

Once you have selected the option you require then to go back to the main menu you press **PHONE HANG-UP/MUTE**, this will return you to the previous menu.

**Time Date**  
**Vehicle Settings**  
**Logo Select**

The same actions are applied to whatever menu you wish to change.

Double DIN Kit contents

- (1) Facia Plate
- (2) Mounting Bracket Left
- (3) Mounting Bracket Right
- (4) Fixing screws
- (5) Speaker
- (6) Stalk Interface
- (7) Lead Cable
- (8) Pocket (1-DIN install)

## Installation Manual Double DIN Kit

### • Opel Astra (J) 2010->

CTKVX01 - Titan Grey

CTKVX04 - Peark Black

CTKVX05 - Platinum Silver

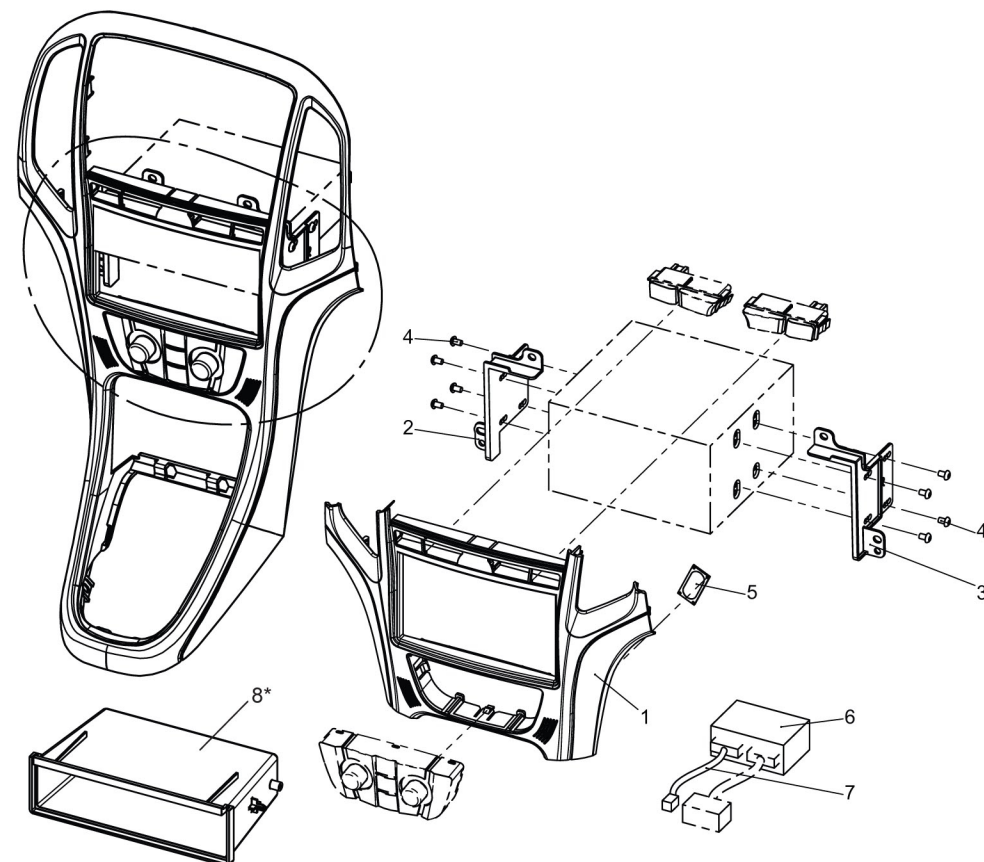



1. Unclip gear shift cover

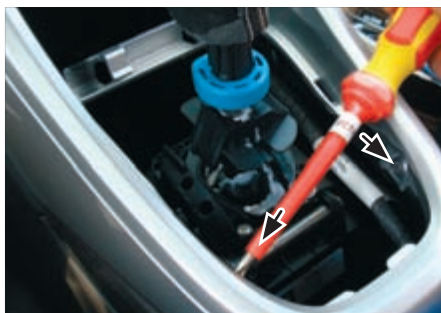

2. Remove screws of OEM center panel



3. Unclip OEM center panel  
Remove OEM center panel

2

## Steering wheel control interface install guide

1



2

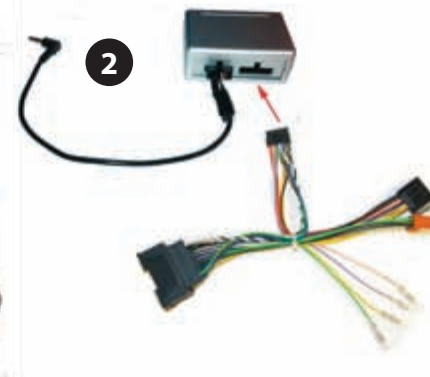

3

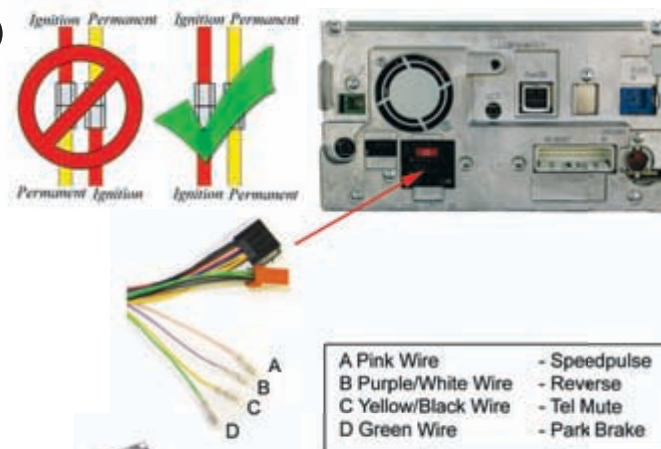

4

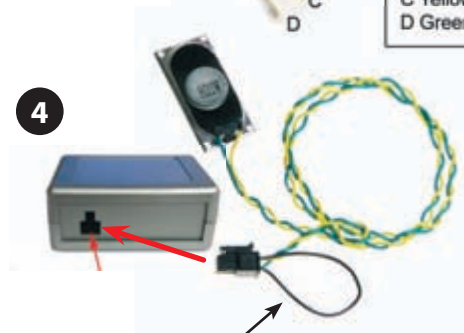

5

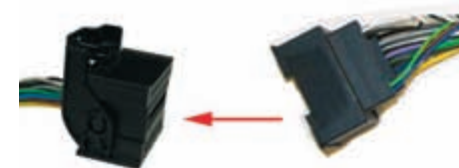

A - vehicles with 4 line dash display only:

**Cut and insulate this (black) loop**

B - Connect speaker to slot in facia plate

Vehicle Plug

interface connector

7





15. Cut away top of cigarette lighter unit: along the dashed line.

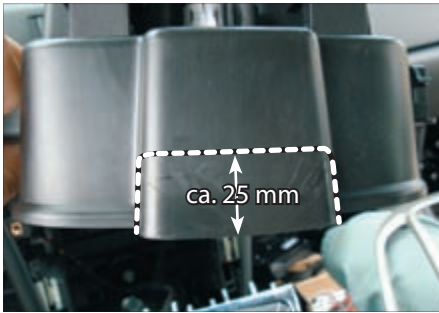

16. Top view of cigarette lighter unit: cut along the dashed line

Caution: measure before you cut!

Reinstall cigarette lighter unit



17. Place facia plate  
Reinstall everything in reverse order to finish installation



4. Remove cigarette lighter unit.



5. Open cover below air vent (left and right)

Remove screws of OEM control unit



6. Remove screws of OEM control unit

Remove OEM control unit

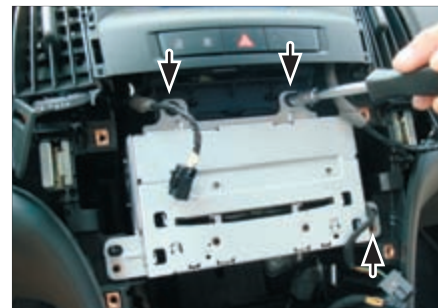

7. Remove screws of OEM head unit

Remove OEM head unit

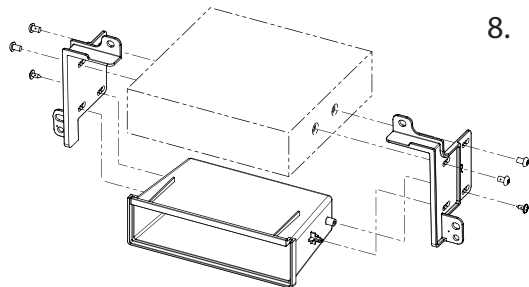

### 8. **1-DIN radio:**

Attach mounting brackets to double DIN head unit

Fix them with four screws

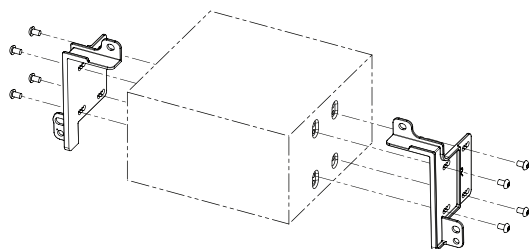

### **2-DIN navigation:**

Attach mounting brackets to double DIN head unit

Fix them with four screws

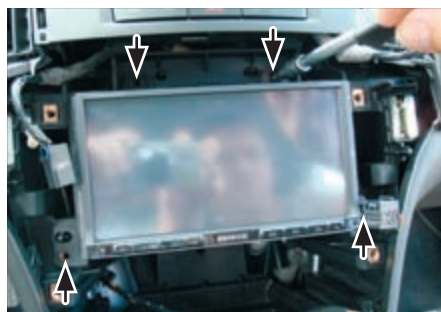

9. Connect steering wheel control interface (see page 7)

*Go to page 7 for a detailed installation guide of steering wheel control interface*

Fix double DIN head unit



10. Unclip air condition control unit from OEM panel



11. Mount air condition control unit to facia plate



12. Remove switch left and switch right from OEM unit

13. Mount switches to facia plate

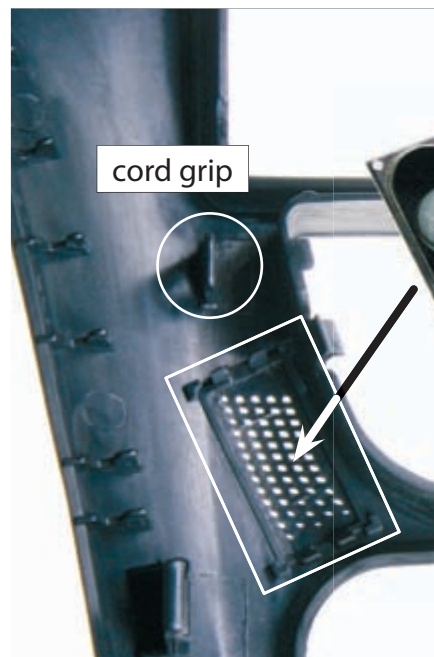

14. Connect speaker plug to steering wheel interface. Mount speaker to facia plate. Use cord grip for securing speaker cable

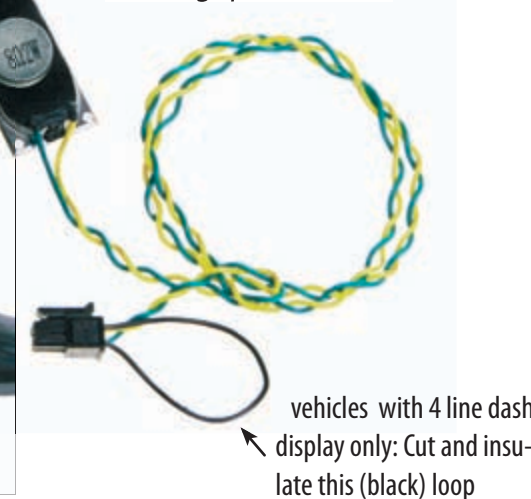

vehicles with 4 line dash display only: Cut and insulate this (black) loop